

HOTEL SERVICES

# Directory

---



17TH STREET AND BOARDWALK | OCEAN CITY, MARYLAND

# HOTEL GUEST DIRECTORY



*It is our pleasure* to have you as our guest and to welcome you to Ocean City, Maryland.

We want to assure you that your stay with us is comfortable and relaxing. If you have any questions or need assistance please don't hesitate to ask one of our courteous staff members for help.

Our management and staff are committed to ensuring that your needs are met. We thank you for giving us the opportunity to serve you. Our beaches are wide and our ocean is blue so relax and have a wonderful time while you're here with us.

BOARDWALK & 17TH STREET  
1601 ATLANTIC AVE | OCEAN CITY, MD 21842  
410-289-4401 | [WWW.QIBOARDWALK.COM](http://WWW.QIBOARDWALK.COM)



# DIRECTORY OF SERVICES

---

## AIRPORTS

### OCEAN CITY MUNICIPAL AIRPORT . . . 410-213-2471

Located approximately 3 miles west of town on Rt. 611 (Stephen Decatur Memorial Rd.) Charter and regularly scheduled flights leave and arrive daily.

### SALISBURY/OCEAN CITY/WICOMICO REGIONAL AIRPORT . . . . . 410-742-4190

Located off Mt. Hermon Rd., east of Salisbury with charter and regularly scheduled flights to Baltimore and Washington.

## AIR CONDITIONING & HEATING

Before attempting to turn on the air conditioner or heat, please be sure to close the windows and doors. Leaving these open will automatically shut-off the heating or cooling unit. Air conditioning and heat is controlled seasonally.

## ALCOHOLIC BEVERAGES

Consumption of alcoholic beverages in public areas other than those specified is prohibited.

### BANQUETS . . . . . 410-289-1470

Can be arranged through Group Sales

## CHURCH SERVICES

Consult our listing (located in the lobby near the elevator).

## CHECK-OUT TIME

Check-out time is 11:00AM. Please leave keys at the front desk.

**COFFEE** 24 hour coffee service available in the lobby.

## CREDIT CARDS

American Express, Visa, Mastercard, Discover Card.

### PACK N' PLAYS . . . . . EXT. 61

Provided at no extra charge. Based on availability.

### EMERGENCY . . . . . EXT. 61

Please contact the manager on duty or call the operator.

### EXERCISE ROOM . . . . . EXT. 61

Located in the indoor pool area. Limited to guests 18 years of age or older. 8am - 12pm

## FORGOT SOMETHING?

Various bathroom accessories available at front desk.

## FREE DAILY NEWSPAPER

AVAILABLE AT THE FRONT DESK

### FRONT DESK . . . . . EXT. 61

**GUEST LAUNDRY** Located in the indoor pool area.

Machines are free of charge.

### HOUSEKEEPING . . . . . EXT. 61

### HOTEL OPERATOR . . . . . EXT. 61

## ICE

On the 1st and 5th floors to the right off the elevator.

On the 4th floor across from rooms 418-419.

## INTERNET ACCESS

Please see next page

## KEYS

When checking out, leave your room key at the front desk.

## LOCAL TOUR INFORMATION

- Inquire at the front desk.

### LOST & FOUND . . . . . EXT. 61

### MAINTENANCE PROBLEMS . . . . . EXT. 61

We like the best for our guests, so please, no matter how minor, report any problems to the front desk, upon notice.

### MESSAGES . . . . . EXT. 61

To leave or receive messages.

### MANAGER ON DUTY . . . . . EXT. 61

## NOISE CONTROL

Respect the rights of the other guests who wish a quiet stay. Excessive noise could result in eviction and loss of funds.

## OUTDOOR RECREATIONAL FACILITIES

Two outdoor oceanfront pools and a pool bar and lunchstand are located between the boardwalk and hotel.

## PARKING

Free parking is provided in front and across from hotel on Baltimore Avenue. 1 parking space per room.

## PETS

We are sorry, we do not have accommodations for pets. If you are traveling with your pet, we can recommend a nearby kennel for your pet's board.

## PHONE CALLS

Local calls are free. Long distance calls will be charged according to length of call.

## RAINY DAYS

There are games, puzzles, checkers and much more at the front desk for you to borrow. Other rainy day activities available.

### RESERVATIONS . . . . . EXT. 61

We will be happy to make your advance reservations at any time. Please contact reservations or the front desk.

### RESTAURANT . . . . . EXT. 7200

Located off the main lobby.

## IN ROOM SAFES ARE SUPPLIED IN EACH ROOM

## SODA MACHINES

We have vending machines conveniently located throughout the hotel. In front of elevators on floors 3, 6, 7 & 8 and in the lobby area.

## SWIMMING POOLS & JACUZZI

Outdoor pools are open until sundown each day seasonally. The heated indoor pool area offers a jacuzzi from 8am - until 12 midnight.

### SWITCHBOARD . . . . . EXT. 61

Open 24 hours a day.

## YOUR ROOM

Is fully equipped with towels, soap, toilet tissue, blankets (winter season), and other accessories according to your needs. We request that these accessories remain in the room. If you require additional accessories, contact the front desk.

# HOTEL PHONE NUMBERS

**DIRECTORY ASSISTANCE** .....  
..... **DIAL 9 + 1 + (AREA CODE) + 555-1212**  
Directory Assistance for long distance numbers.

**EMERGENCY** ..... **DIAL 911**

**LOCAL CALLS** ..... **DIAL 9 + 410 + NUMBER**

**LOCAL DIRECTORY ASSISTANCE** ..... **DIAL 9 + 411**

**LONG DISTANCE CALLS** .....  
..... **DIAL 9 + 1 + (AREA CODE) + NUMBER**  
Long distance calls charged to your room.

**LONG DISTANCE CALLS** .....  
..... **DIAL 9 + 0 + (AREA CODE) + NUMBER**  
Collect or credit card calls.

**WAKE-UP CALLS** ..... **EXT. 61**

## HIGH-SPEED WIRELESS INTERNET ACCESS

**CONNECT TO THE WIRELESS:** For wireless use in guest rooms, hotel lobby, business center, and any public areas: Using your device's wireless connection, search for wireless networks and connect to your venue's network name or SSID. Proceed to sign-in.

**SIGNING IN:** Third-party software security enhancements may prevent your device from reaching the login page. Open your web browser and visit a non-HTTPS page such as [wifi123.org](http://wifi123.org). You will be directed automatically to the sign-in page. Once you read and agree to the Terms of Service, enter the access code provided by the front desk and the click "I Agree." You will then be redirected to the Home Page and allowed to use the internet.

**TROUBLE CONNECTING:** Guest WiFi networks require you to login. If you are having issues connecting to the WiFi, it is always best to reboot your device and try reconnecting. This clears any previous connections and should allow you to reach the login page.

**GAME CONSOLE AND STREAMING MEDIA BOXES:** If you are traveling with an Xbox, PlayStation, Roku, Apple TV or other media device and are having problems connecting, please locate the MAC address and call our support team to have your device authenticated.

**24-HOUR TECHNICAL SUPPORT**  
**(866) 438-0216**

## TIPS ON WHAT TO DO IN CASE OF A FIRE

1. If you discover a fire or smell smoke, sound the building alarm. The location of all fire alarm pull stations is illustrated in the diagram located on the back of your hotel room door.
2. Do not use the elevators. Elevators are like chimneys. Smoke could enter the elevator shaft, thereby asphyxiating anyone trying to evacuate the building, or become inoperative, trapping occupants.
3. Use the stairs. Calmly proceed to the nearest stairway.
4. If fire alarms sound, feel the door of your room before opening. If hot or smoke is seeping in, do not open. Use wet towels or sheets to seal off any cracks.
5. Fill the tub with water. It might be needed for firefighting.
6. Use the telephone in your room to call the hotel operator and let the operator know your room number
7. If door is cool, open cautiously. Be ready to close it rapidly if hall is full of smoke or you feel pressure against the door. If hall is clear, leave your room and close your door behind you. Proceed to the nearest exit.
8. When in smoke or heat, stay low where the air is better. Take short breaths (through nose) until you reach an area of safety.

# LOCAL BUSINESS & RETAIL NUMBERS

## EMERGENCY PHONE NUMBERS

Police - Fire - Ambulance	911
Marine Police	410-548-7070
Beach Patrol	410-289-7556
Coast Guard	410-289-7559

## LOCAL INFORMATION

AAA	410-860-2885
Alcoholics Anonymous	410-600-5219
Chamber of Commerce	410-213-0552
City Hall	410-289-8221
Post Office - 71st Street	410-524-7611
Post Office - 408 Philadelphia Ave.	800-275-8777
Time	202-762-1401
Dial a Buoy / Marine and Weather Forecast (Coordinates: 38.3365° N, 75.0849° W)	888-701-8992
Western Union	800-325-6000

## BANKS

M&T	410-208-4247
BB&T	410-524-7333
Bank of Ocean City	410-524-6144
SunTrust	410-213-5338
Bank of America	410-289-6818
Peninsula Bank	410-250-3000
Taylor Bank	410-289-8171

## HEALTH CARE

Atlantic General Hospital	410-641-1100
A.G.H. Townsend Medical Center	410-289-6241
75th Street Medical Center	410-524-0075
West Ocean City Injury & Illness Center	410-213-0119

## CHURCHES

Atlantic United Methodist 4th Street & Baltimore Ave.	410-289-7430
Baptist Chapel of Ocean City 12637B Ocean Gateway	410-289-6573
Holy Trinity Cathedral Rt. 113 at Rt. 90 Overpass	410-641-4882
First Presbyterian Church 13th Street & Philadelphia Ave.	410-289-9340
Worship Center (Assembly of God) 10736 Ocean Gateway	410-641-3325
Holy Savior Catholic Rectory 17th Street & Philadelphia Ave.	410-289-0652
St. Andrew's Catholic Center 144th Street Bayside	410-250-0300
St. Mary's Star of the Sea Catholic 208 Baltimore Ave.	410-289-0652
St. John Neumann Catholic Ocean Pines	410-208-2956
St. Luke's Catholic 100th Street & Coastal Highway	410-250-0300
St. Paul's By the Sea Episcopal 302 Baltimore Ave.	410-289-3453
St. Peter's Lutheran Church 10301 Coastal Highway	410-524-7474
St. George's Greek Orthodox 8805 Coastal Highway	410-524-0990
Episcopal of the Holy Spirit 100th Street & Coastal Highway	410-723-1973

## CHURCHES (continued)

Berlin/Ocean City Lighthouse Church of God Sinepuxent & Lewis Road, West Ocean City	410-641-1171
Son'spot Ministries/Spirit Full Life Gospel 12 Worcester Street	410-289-1296
Temple Bat Yam/Daughter of the Sea Reformed Jewish Services Rt. 113, Berlin	410-641-4311

## TRANSPORTATION

Taxi Taxi	410-289-8989
Greyhound / Carolina Trailways Bus	800-231-2222
Municipal Bus Information	410-723-1606
O.C. Municipal Airport	410-213-2471
Salisbury/Ocean City/Wicomico Airport	410-548-4827
American Airlines	800-433-7300
Enterprise Car Rental	410-213-0886

## SHOPPING

Gold Coast Mall 114th Street & Coastal Highway	410-524-9000
Ocean City Outlets Rt. 50 & Golf Course Road	410-213-7898
Rehoboth Outlets Rt. 1, Rehoboth Beach, DE	302-226-9223
The Country House Salisbury, MD	410-749-1959

## GOLFING

Glen Riddle	410-213-2325
Lighthouse Sound	410-641-1189
Eagle's Landing	410-213-7277
Nutters Crossing	410-860-4653
O.C. Golf & Yacht Club	410-641-1779
River Run	410-641-7200
Rum Pointe	410-629-1414

## BOATING & WATERSPORTS

The Explorer - Boat Cruise	410-289-0004
Miss Ocean City - Deep Sea Fishing	443-353-0888
O.C. Princess - Deep Sea Fishing	410-289-6226
Off Shore Nature Cruise	410-213-0926
The Sea Rocket - Ocean Speedboat Ride	410-289-4386
White Marlin Marina	410-289-6470
O.C. Rocket - Speed Boat Ride	410-289-3500
Inlet Sea Doos	410-289-1488

## SPORTS & RECREATION

Ocean Downs & Casino (harness racing)	410-641-0600
The Delmarva Shorebirds (baseball)	410-219-3112
Old Pro Golf (indoor miniature golf)	410-524-2645
Ocean Lanes (bowling)	410-524-7550

## AMUSEMENTS & ARCADES

Baja Amusements	410-213-2252
Frontier Town - Wild West Theme Park	800-228-5590
Trimper Amusements - Boardwalk	410-289-8617
Fun City Arcade	410-289-4133
Marty's Playground Arcade	410-289-7271
Jolly Roger	410-289-3477



# LOCAL BUSINESS & RETAIL NUMBERS continued

---

## **THEATRES**

Gold Coast Theatre ..... 410-213-1505  
Sun & Surf Cinemas ..... 410-250-1777  
Flagship Premium Cinemas ..... 443-664-7554

**BOARDWALK TRAIN** Summer Schedule Runs the length of the Boardwalk every 20 minutes for a nominal fee.

## **MUNICIPAL BUSES**

City buses run seven days a week from the Inlet to the Delaware State line. The buses leave approximately every 5 minutes from 6:00AM to 2:00AM. The buses leave every 30 minutes from 2:00AM to 6:00AM. \$3 for an all day pass. This is the summer schedule, please call 410-723-1606 for the winter schedule.

# LOCAL ATTRACTIONS

---

## **OCEAN CITY LIFE SAVING STATION MUSEUM**

In Ocean City, MD at the Inlet & Boardwalk  
Originally built in 1891, this museum was the actual home to the United States Life Saving Service for several years. Exhibits include aquariums, shipwrecks, artifacts, doll houses, programs, photographs and numerous small exhibits. Weekly educational programs for groups are available in July and August. For information call 410-289-4991

## **WARD MUSEUM OF WILDFOWL ART**

In Salisbury, MD, 35 minutes west of Ocean City on Rt. 50. See wood come alive in this unique display of wildfowl carvings representing the top works of the finest contemporary carvers and the best classic hunting decoys in the nation. Open year round. For information call 410-742-4988.

## **JULIA A. PURNELL MUSEUM**

In Snow Hill, MD, approximately 40 minutes south of Ocean City on Rt. 113. A showcase of area lore from Indian and Colonial times to the Victorian era; artifacts from the medical, cooking, farming, sewing and clothing areas housed in a quaint historic structure. Open year round. For information call 410-632-0515.

## **NASSAWANGO IRON FURNACE**

In Snow Hill, MD, approximately 40 minutes south of Ocean City on Rt. 113. 1840's industrial village re-created; includes narration on Furnace Town buildings (country shop, museum, blacksmith, woodwork, broom making, print shop and more), iron furnace and grounds. Open year round. For information call 410-632-2032.

## **CHESAPEAKE BAY MARITIME MUSEUM**

In St. Michaels, MD, approximately 1 hour west of Ocean City on Rt. 50. Explore 16 acres of exhibits on the history of the Bay and its traditions in boat building, commercial fishing, yachting, waterfowl and navigation. Special feature is the 100 year old Hooper's Strait Lighthouse. Open year round. For information call 410-745-2916.

## **OCEAN CITY OUTLETS**

In West Ocean City, MD, Rt. 50 & Golf Course Road  
Ocean City's premier shopping center featuring 40 of the nation's top brand name manufacturers. Save 20-70% off regular retail prices. Preferred shopper cards are available for a discount. Open year round. Closed Easter and Christmas Days. For information call 410-213-7898.

## **SALISBURY ZOO**

In Salisbury, MD, 35 minutes west of Ocean City on Rt. 50. See the many exhibits the Salisbury Zoo has to offer. Learn about bears, monkeys, jaguars, waterfowl and much more. For more information call 410-548-3188.

## **SMITH ISLAND CRUISES**

In Rhodes Point, MD, approximately 1 1/2 hours southwest of Ocean City. Smith Island is Maryland's only inhabited island accessible exclusively by boat. Stroll the island, take a bus tour or visit the new museum. Lunch can be included. Cruise time: 1 1/2 hours. Seasonal. For information call 410-425-2771

## **BAY CRUISES**

In Crisfield, MD, approximately 1 hour southwest of Ocean City. Take a ride on one of the large Bay Cruise Boats to and from Tangier or Smith Island discovered by Captain John Smith in the 1600's. Seasonal. For information call 410-968-2338.

## **OCEAN DOWNS CASINO**

In Berlin, MD, approximately 10 minutes away from Ocean City on Rt. 50 & 589. Featuring live and simulcast harness racing, dining, table games and slot machine entertainment. The Clubhouse offers special group rates and events as well as dinner and buffets. Have a race named in the honor of your group, and if you win, you'll stand in the winner's circle. Seasonal. For more information call 410-641-0600.

## **THE DELMARVA SHOREBIRDS**

In Salisbury, MD, approximately 35 minutes west of Ocean City on Rt. 50. The Shorebirds are a Class A affiliate of the Baltimore Orioles, and were the South Atlantic League Champions in 1997. The state-of-the-art Arthur W. Perdue Stadium offers several outdoor cafes, numerous concession stands and a playground. Seasonal. For more information call 410-219-3112.

## **ASSATEAGUE NATIONAL PARK**

In Assateague Island, MD, approximately 40 minutes south of Ocean City. The southern most part of the natural barrier reef, stretching from the Ocean City inlet to the Virginia border. Miles of beach and dunes protected as a national park. Wild ponies, nature trails, picnic areas, fishing and boating. Beach and special programs are available. Open year round. For more information call 410-641-1441.

## **CHINCOTEAGUE WILDLIFE REFUGE**

In Chincoteague, VA, approximately 50 minutes south of Ocean City on Rt. 113. Nature at its finest, home of many endangered species in this lush refuge featuring Chincoteague ponies, many wildfowl species, deer and more nestled between the Atlantic Ocean and Chincoteague Bay. Open year round. For information call 757-336-6122.

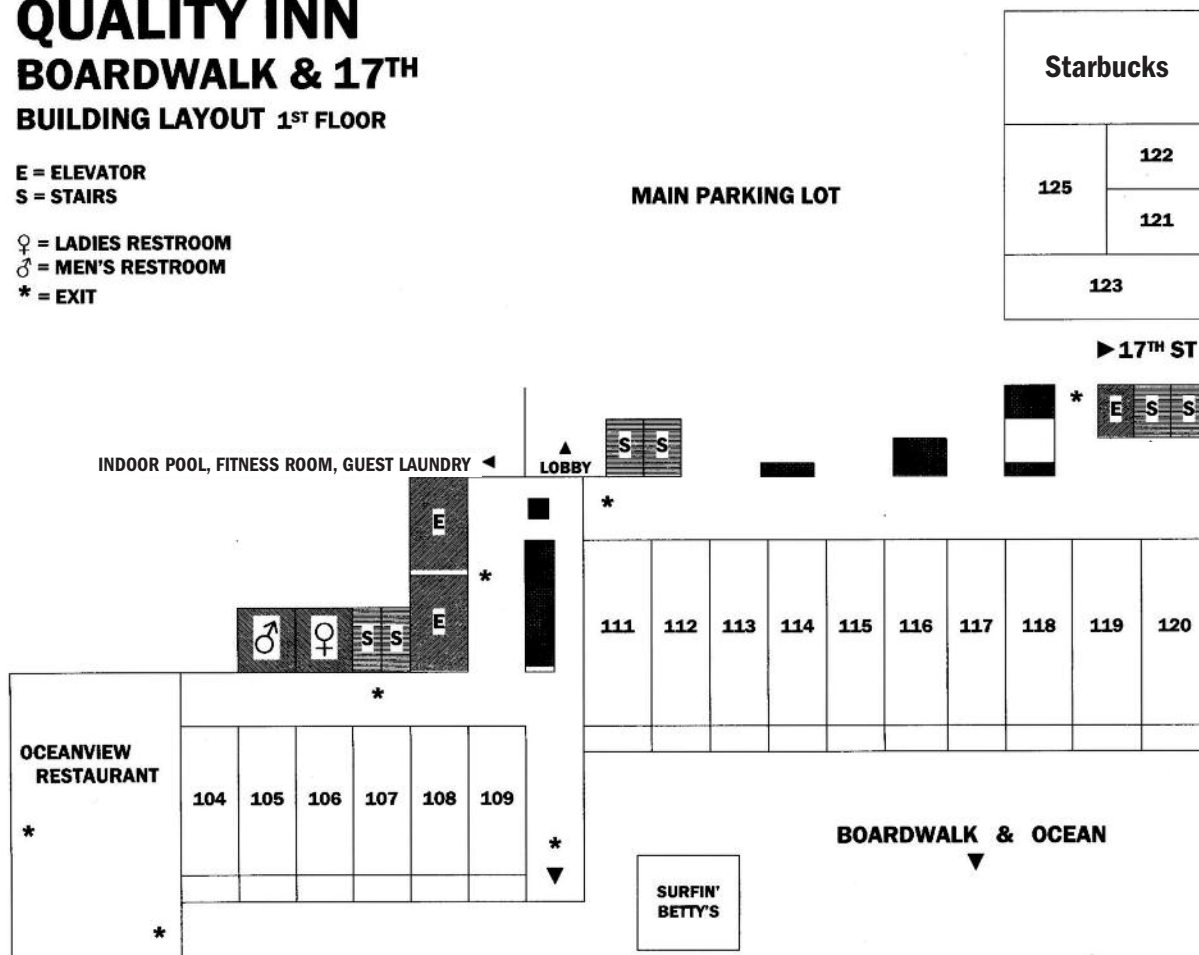
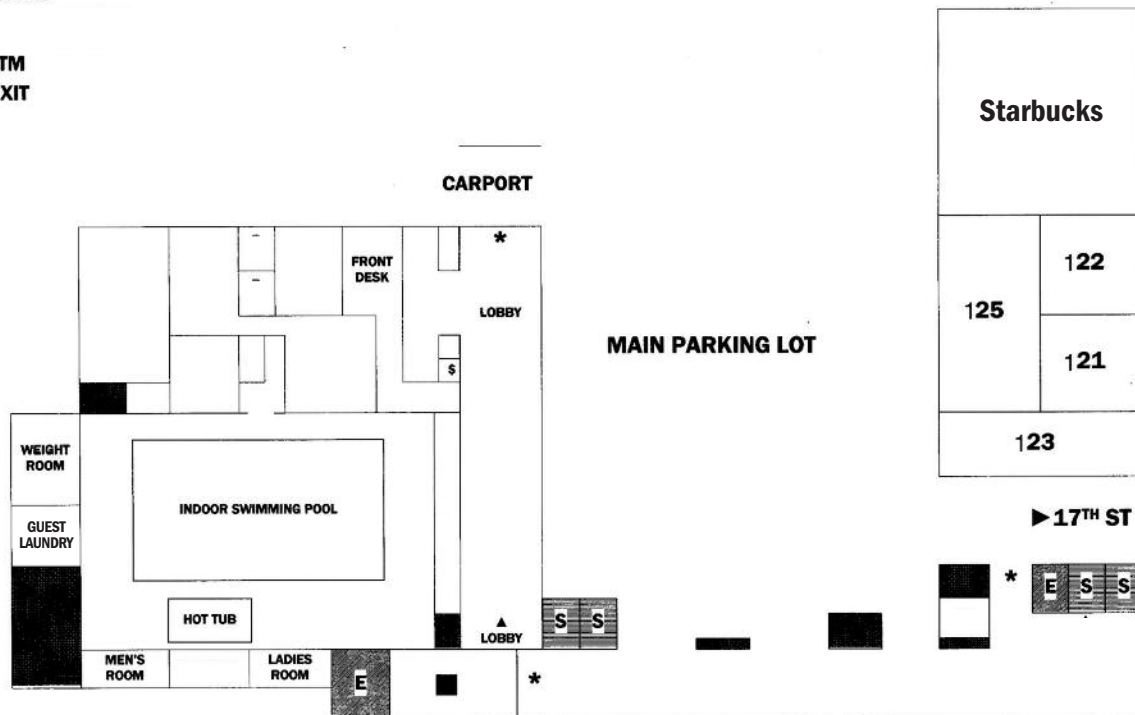

# QUALITY INN

## BOARDWALK & 17<sup>TH</sup>

### BUILDING LAYOUT 2<sup>ND</sup> 3<sup>RD</sup> 4<sup>TH</sup> 5<sup>TH</sup> FLOORS

E = ELEVATOR  
S = STAIRS

\* = EXIT

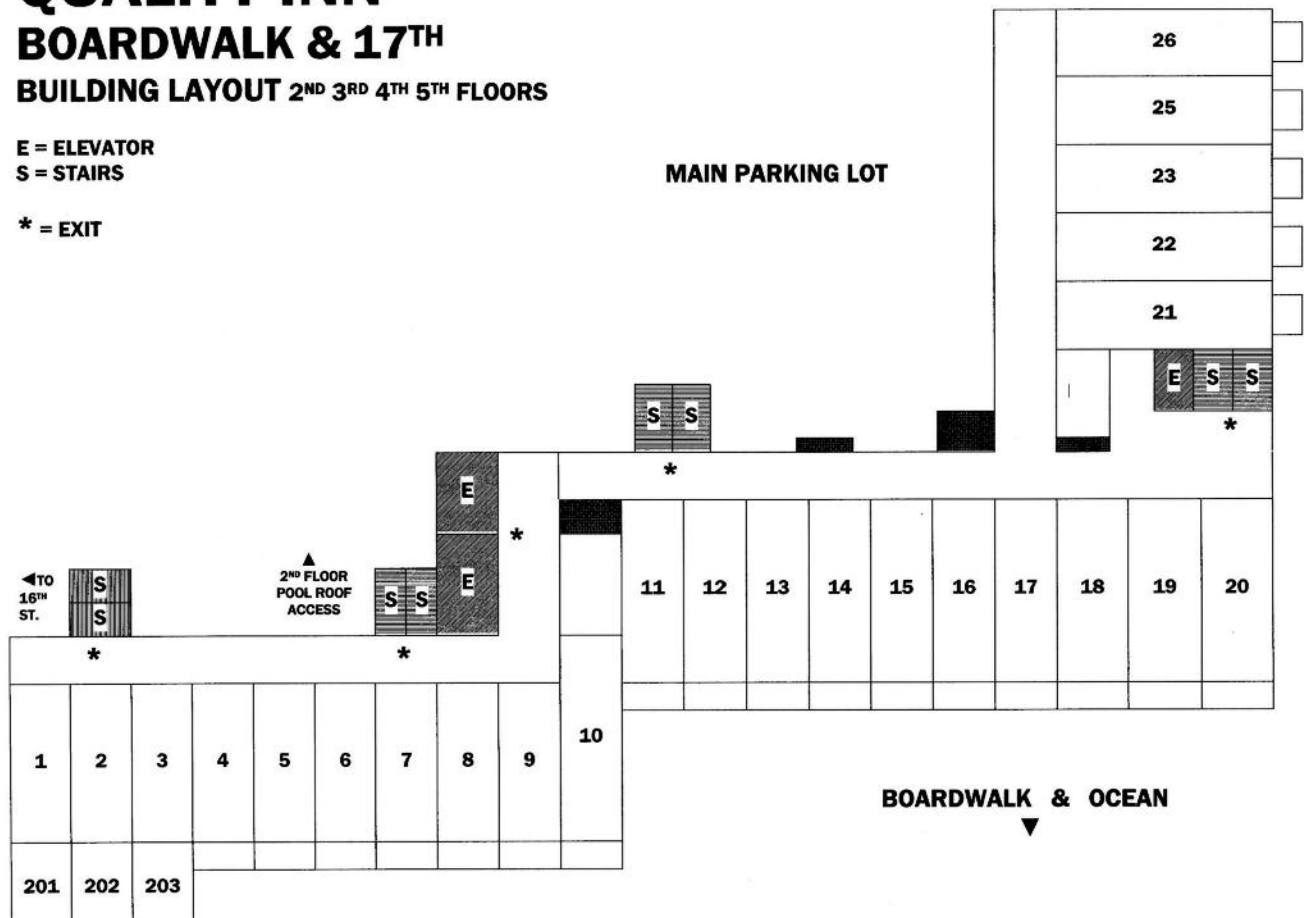

# QUALITY INN

## BOARDWALK & 17<sup>TH</sup>

### BUILDING LAYOUT 6<sup>TH</sup> FLOOR

E = ELEVATOR  
S = STAIRS

\* = EXIT

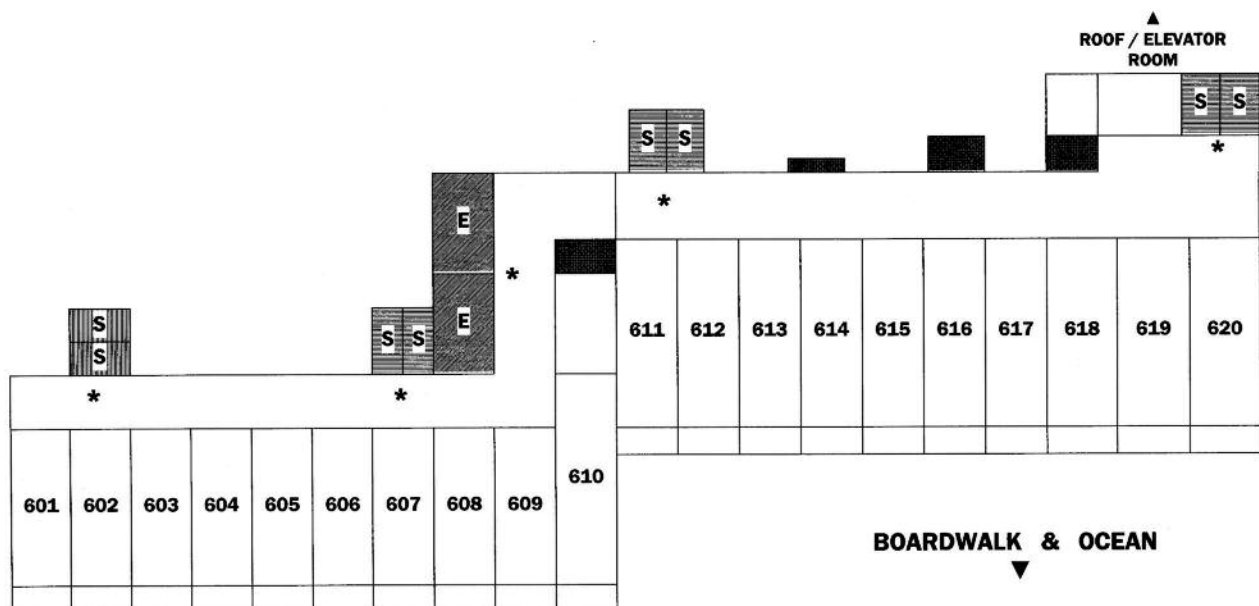



# QUALITY INN

## BOARDWALK & 17<sup>TH</sup>

### BUILDING LAYOUT 7<sup>TH</sup> 8<sup>TH</sup> 9<sup>TH</sup> FLOORS

E = ELEVATOR  
 S = STAIRS  
 \* = EXIT

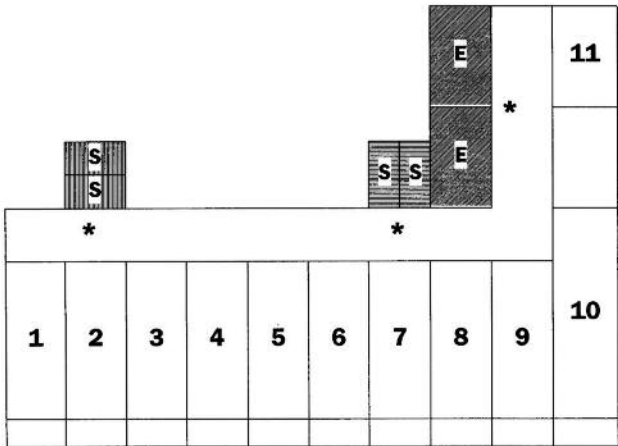

MAIN PARKING LOT

BOARDWALK & OCEAN  
 ▼

# QUALITY INN

## BOARDWALK & 17<sup>TH</sup>

### BUILDING LAYOUT LOWER PENTHOUSE

E = ELEVATOR  
 S = STAIRS  
 GL = GUEST LAUNDRY  
 RR = RESTROOM  
 KT = KITCHEN  
 □ = EMERGENCY EXIT  
 ☼ = SPIRAL STAIRS  
 \* = EXIT

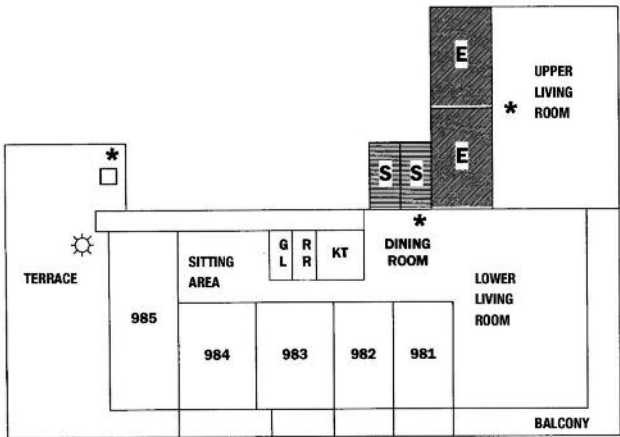

# QUALITY INN

## BOARDWALK & 17<sup>TH</sup>

### BUILDING LAYOUT UPPER PENTHOUSE 970

E = ELEVATOR  
 S = STAIRS  
 GL = GUEST LAUNDRY  
 RR = RESTROOM  
 KT = KITCHEN  
 ☼ = SPIRAL STAIRS  
 \* = EXIT

